



Tax Systems

AlphaCT

1.7 Release Notes

3 April 2024

Contents

1. Introduction.....	3
About this document.....	3
Technical support.....	3
2. AlphaCT 1.7 Release.....	4
Welcome to AlphaCT	4
Key enhancements.....	4
Known bugs or limitations.....	7
Top tips	7

1. Introduction

About this document

This document provides an overview of the latest AlphaCT release, including:

- Key items included in this release.
- Known bugs or limitations.

Technical support

We provide a technical support help desk for users requiring assistance. The help desk can be contacted by telephone between the hours of 9.00 am and 5.30 pm, Monday to Friday excluding public holidays.

Region	Telephone	Email
UK	+44 (0) 1784 777 666	support@taxsystems.com
Ireland	+353 (0) 1661 9976	support@taxsystems.ie

2. AlphaCT 1.7 Release

Welcome to AlphaCT

Welcome to AlphaCT 1.7. These release notes outline the main changes in this release. We continue to work on major features for future releases and look forward to sharing these with you soon.

Feedback

Your feedback is important to us as we consider the next steps in improving and extending AlphaCT. We would love to hear your feedback on how you found the experience of using AlphaCT and any ideas that you have which can help us make the product even better.

We have created a feedback portal and encourage you to add feedback and ideas and explore and feedback from other users. The portal allows you to view and upvote feedback from other portal users and receive automatic notifications when we release requested features. Use this link to share your ideas: [Alphatax360 Feedback \(aha.io\)](https://Alphatax360 Feedback (aha.io))

In addition to the above link, you can also access the feedback portal via the AlphaCT Knowledge Centre, which is accessible by clicking the '?' icon in the bottom right-hand corner when logged into AlphaCT.

Key enhancements

Feature enhancements

In this release we have made enhancements to four key features as well as ongoing improvements to the infrastructure and system health.

E-filing

- If you elect to discard an e-filing assembly, your attachments and selections on the Attachments tab will now be retained by default. Optionally, these can also be removed as part of the discard process. Attached documents you retain will also remain in Document Manager.
- When a company is migrated from Alphatax to AlphaCT, the E-filing audit trail data will now be migrated and displayed alongside new audit trail items in AlphaCT.

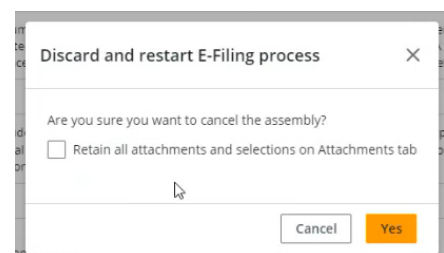

Support

- In the previous release we introduced the ability for users to provide the Support team with a copy of a period to help them identify any issues. In this release we have extended this feature, adding options for users to:
 - Provide the whole company or just a period,
 - Send multiple periods or companies related to the same Support Ticket number,
 - Withdraw support team access from the computation, and an auto-expiry of a copied file.

Review notes

- Users now have the option to carry forward review notes to the next period. All details of the review note will be carried forward, including but not limited to, the original note, title, responses, and tags.

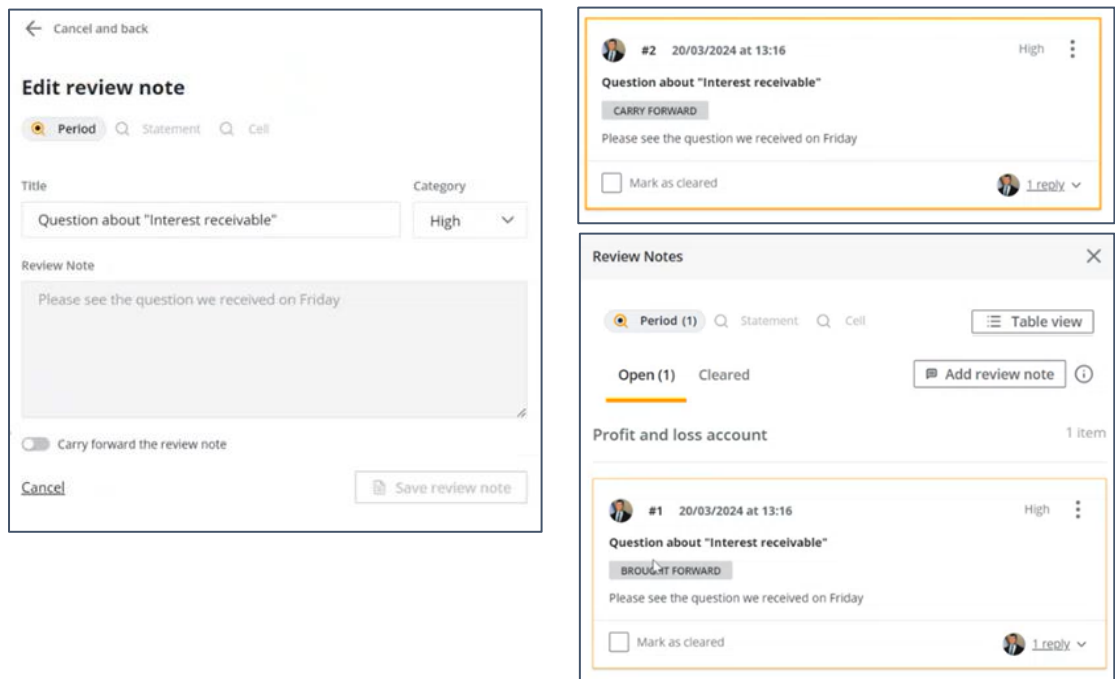

- If a review note is added to an accessory form input, AlphaCT now supports direct navigation to the accessory form input.
- Users can export details of review notes to Excel from the Review notes summary. When doing this, the details now include the Cell value (text or value).

Migration

- We have refined how we are processing entities as they migrate, which will reduce the time it takes to migrate entities from Alphatax.
- Entity migrations can now be cancelled while in progress, to save you from having to wait for the process to complete, should you wish to cancel.
- Should any migration reach a Failed status, e.g. due to network disruption, this will automatically retry to save you from having to trigger the migration process again.

Bugs

We have fixed bugs in several key areas of the product, focusing on usability.

We continue to focus on ensuring a high-quality user experience by fixing any issues that are identified during testing, or by users. Please let us know if you experience any issues, so we can prioritise them accordingly.

Known bugs or limitations

The following bugs or limitations have been identified in the current release. Remediation changes are planned to resolve each of these issues:

Features	Limitation
Keyboard shortcuts & mouse right-click menu	<p>The mouse right-click menu functions in a similar manner to desktop Alphatax, however please note that some keyboard shortcuts will differ because existing shortcuts in the desktop product are used by the browser to perform different actions.</p> <p>Keyboard shortcuts have not all been implemented to date and will be included in a later release.</p> <p>Primary keyboard shortcuts are detailed in the online help guide.</p>
Currency translation Brought forward currency rate	<p>Any values in the b/f translation rate will roll forward when a new period is created.</p> <p>Workaround: Unwanted b/f values should be manually amended or deleted.</p>
Orphaned statements	<p>If orphaned statements are migrated as part of an Alphatax computation, then they will currently display in an incorrect area of the Contents Tree and cannot subsequently be removed.</p> <p>Workaround: Orphaned statements should be addressed or removed from the ATE file prior to migration until this issue is resolved. Please ask your migration team if you have any questions on this.</p>

Top tips

Switch between input and report mode	Press Ctrl_Shift_R to switch between input and report mode.
Printing your computation	<p>AlphaCT renders the tax computation in HTML format. The printing function in your internet browser can be used to print to PDF.</p> <p>Select the Save as PDF option (certain other drivers such as Microsoft Print to PDF may produce large file sizes).</p>

Please share your product feedback and ideas with us using our ideas portal: [Alphatax360 Feedback \(aha.io\)](https://aha.io)



This document and all the information contained within, including, but not limited to, content, processes, and product names, are the property of Tax Computer Systems Limited and all such rights are reserved.

This document should be kept confidential. No part of this document may be reproduced, or transmitted, in any form by any means; or shared in any way with anyone outside of your organisation, without the written permission of:

UK Headquarters

Tax Computer Systems Limited
Magna House, 18 – 32 London Road
Staines-Upon-Thames
TW18 4BP

Enquiries: +44 (0) 1784 777 700

Support: +44 (0) 1784 777 666

Email: enquiries@taxsystems.com

Ireland Headquarters

Tax Computer Systems Limited
7 Herbert Street
Dublin 2
DO2 CY22

Enquiries: +353 (0) 1661 9977

Support: +353 (0) 1661 9976

Email: support@taxsystems.ie

Copyright © Tax Systems 2024

All Rights Reserved.